

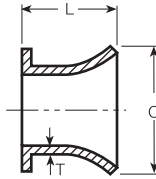

AMERICAN Ductile Iron Specials Flare† Castings



Flange and Flare

Table No. 7-8

Size in.	Pressure Rating psi	Dimensions in Inches				Weight in Lbs (Min. Length)
		T	L Minimum	L Maximum	C	Flg & Flare
4	250	.52	8	8	9.00	40
6	250	.55	8	8	11.00	65
8	250	.60	10	10	13.50	105
10	250	.68	10	10	16.00	145
12	250	.75	12	12	19.00	210
14	250	.66	12	36	21.00	240
16	250	.70	14	36	23.50	310
18	250	.75	14	36	25.00	370
20	250	.80	13	36	27.50	435
24	250	.89	18	66	32.00	680
30	250	1.03	15	66	38.75	960
36	250	1.15	14	66	46.00	1265
42	250	1.28	12	72	53.00	1260
48	250	1.42	18	72	59.50	2375

† This fitting is sometimes referred to as "bell mouth."

* 54" and 60" castings have wall thicknesses that are per AWWA C153. All other wall thicknesses are per AWWA C100.

** Contact AMERICAN for 64" Flare dimensions.

Flare castings or fabrications can be furnished in a variety of lengths and with wall collars when specified. Flange or mechanical joint bell to be installed flush with the wall should be specified "tap for studs."

The addition of a wall collar to flare castings may affect the minimum length of the casting.

Other joints can be furnished in lieu of flanges or MJ bells in most sizes.

Since above fittings are not included in AWWA C110, L and C dimensions above should be specified on engineering drawings.

See general notes on page 7-1.